



Lottie II

Gayton Marina

£49,950

A 58ft 2002 Black Prince 4 berth cruiser stern narrowboat

A cruiser stern narrowboat offering a perfect opportunity for live aboard or holidays afloat. The exterior is painted a striking green colour and was last blacked and had anodes fitted in 2019.

The stern steps lead into the first of the bedrooms with a double bed and plenty of storage.

After this, there is a bathroom with a macerator toilet, a shower, basin and and a washing machine.

Attached to this is the mid bedroom. This has a double bed, storage and a full length mirror.

Following on from this is a 'U' shaped galley, well equipped with fridge, under counter sink, microwave, oven and gas hob.

This then leads to the saloon where there is a pull out dining table with chairs, 2 comfortable armchairs, footstool and a TV.

In the saloon, there is a solid fuel stove and the boat has central heating throughout the boat to keep you snug when the temperatures drop.

The bow also has seating so you can enjoy the views while cruising along.

Lottie II has a safety certificate until April 2025.

12 months leisure mooring for the price of 9 at Gayton, Anderton or Alvechurch Marina when purchasing this boat.

To arrange a viewing or make an enquiry, please contact Gayton Marina on 01604 858685

Additional information

Fair condition to external and good condition internal

Scan the QR code to view online



Overall length	58 feet
Beam	6 feet 10 inches
Draft	1 feet 8 inches
Headroom	--
No. of berths	4
Style of stern	Cruiser
BSS certificate expiry	15th April 2025
Built	In 2002 by Black Prince
Fitout	In 2022 by Black Prince
Base	
Hull	
Cabin	
Engine	Isuzu AF/55 35hp
Gearbox	Hurth HSW125H





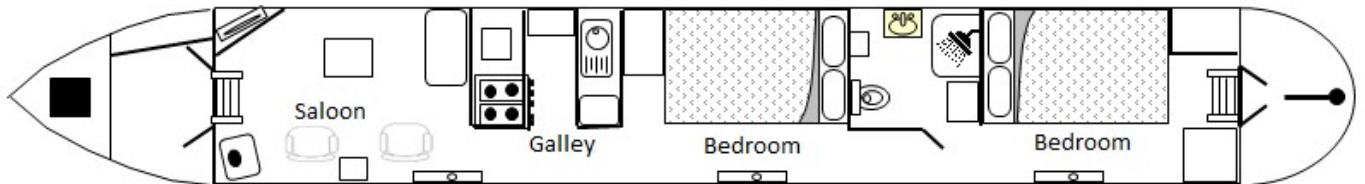



General

General

Name	Lottie II
BW index number	508095
Safety certificate	YES
BSS certificate expiry	15th April 2025
BSS certificate number	BSSER-409523/21
Built	In 2002 by Black Prince
Location	Gayton Marina
Price	£49,950

Berths

No. of Berths	4
Double beds	1
Double beds (temp)	1
Single beds	--
Single beds (temp)	--

Size

Overall length	58 feet
Overall beam	6 feet 10 inches
Overall draft	1 feet 8 inches
Style of stern	Cruiser

Structure

Manufacturer

Manufacturer	Black Prince
Hull ID No.	GB-BPH-B34-H2002
Build date	2002

Original steel thickness

Base	8MM
Hull	6MM
Cabin	4MM

Anodes

Fitted	YES
Date fitted	2019
Size	2.5kg
No. of anodes	4

Material

Base	--
Hull	--
Cabin side	--
Roof	--

Hull blacking

Last hull blacking	2019
Where	Gayton





Running gear

Engine

Make	Isuzu
Model	AF/55 35hp
Year	2002
Fuel	Diesel
Cooling	Skin tank
Hours	--
Last serviced date	2021
Last serviced by	Owner

Gearbox

Make	Hurth
Model	HSW125H
Year	--
Reduction	--
Coupling	aquadrive
Shaft diameter	16 INCH X 12 INCH
Propellor size	--

Capacities

Fuel	225 L
Water	600
Gas type	LPG

No. of gas cylinders	2
Gas cylinder size	--

Interior

Fitted

Fitted by	Black Prince
Date fitted	2022

Materials used

Floor	Carpet
Hull sides	Carpet
Cabin sides	Firestart/polysafe
Deckhead	--
Bulkheads	--
Fittings	brass and alloy





Equipment

In the galley

Cooker type	Vanette
Cooker model	5000 wi
Fridge type	LEC
Fridge model	Ranger
Other	--

Heating

Type	Eberspacher
Make	46336ga
Model	B4W
Fuel	Diesel
Other remarks	--

Hot water

Type	--
Make	C Warm
Model	--
Fuel	--
Other remarks	--
Additional heating	Log Burner Morso in the saloon

In the bathroom

Bath	--
Shower	1 with curtain screen
Hip bath	--
Basin	--
Toilet type	Pump out toilet /Macerator
Toilet make	Sanicom pact
Toilet model	--
Toilet tank capacity	500
Toilet remarks	--

Electrical systems

DC voltage	12
No. of batteries (start)	1
No. of batteries (domestic)	3
Split charging	True
Other	12 amp alternator /galvanic isolator

240 volt electrical systems

Inverter make	pure sine
Inverter rating	3kw
Generator make	--
Generator rating	--
Shoreline	YES
Other	Solar panels fitted

Other

Additional information

Fair condition to external and good condition internal

